

VENUE HIRE INFORMATION — MAIN GALLERY, GROUND FLOOR

FEATURES

- Excellent daylight with large, windows
- Extensive wall space for display
- Plenty of electrical sockets
- Size: approximately 8.68 x 5.79 m / 28'6" x 19'

SUITABLE ACTIVITIES

- Exhibitions
- Arts & crafts and other creative workshops
- Cultural events
- Pop-up events
- Presentations
- Private / evening functions

FACILITIES

- WiFi
- Toilets at the rear or upstairs – both have access limitations for users with disability or mobility issues
- Good flexibility of tables, chairs and display units, according to need
- Access to the garden for morning/lunch/afternoon breaks

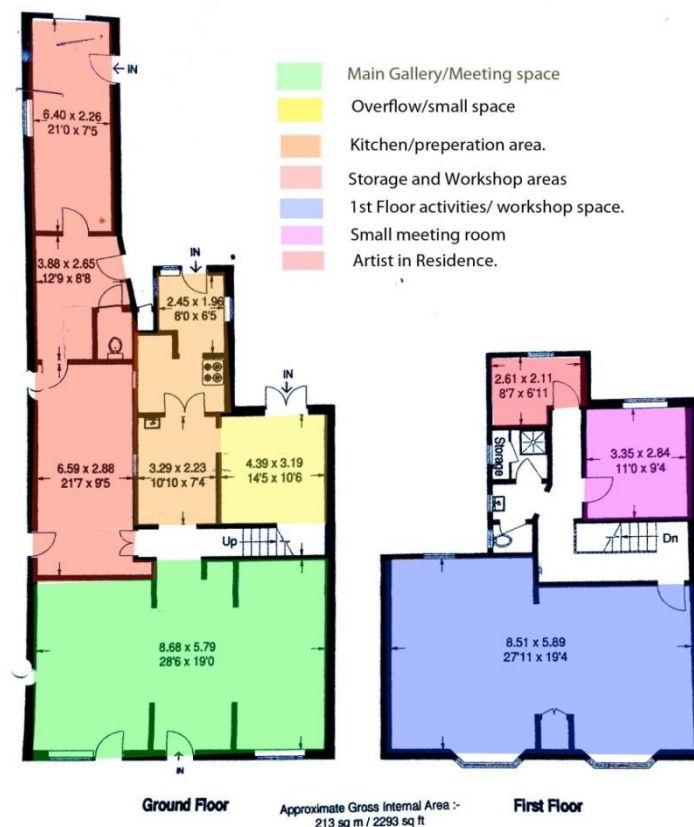

Illustration for identification purposes only,
measurements are approximate, not to scale.

Examples of use for the gallery space:

Art exhibition



Cookery classes



Food tastings



Poetry night



RIGHT:
Outdoor seating areas

